

ESTABLISHING A **NEW STANDARD** IN THE COMMERCIAL REFRIGERATION INDUSTRY.

**LARGE DISPLAY  
CAPACITY WITH MAXIMUM  
ENERGY EFFICIENCY.**



## ➤ KEY FEATURES

### • **BMAD Refrigeration System**

Ensures rapid and effective cabinet cool down and maintains consistent temperature range with minimum energy consumption

### • **Electronic Temperature Controller**

Assures the optimal performance of the cooler, delivering product temperature ideal for consumption.

### • **High Efficiency Glass Door**

Equipped with double panel glass and low-e film to reduce condensation. Door hinge is equipped with a self-closing system to ensure the door closes safely, and returns to original position, without any damages.

### • **LED Lighting System**

Our LED system uses a fraction of the energy of regular fluorescent lights and requires no replacement for up seven years.

### • **CFC and HFC Free Cyclopentane Foam**

Eco-friendly, recyclable and high efficiency cabinet insulation.

### • **Electronic Fan Motors**

Enhances performance and efficiency. Uses only a fraction of the energy than industry standard shaded-pole motor requires. Longer lifespan fan motor.

ESTABLISHING A **NEW STANDARD** IN THE COMMERCIAL REFRIGERATION INDUSTRY.

## PRODUCT VIEWS

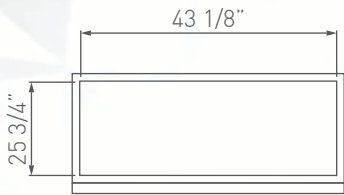

**TOP VIEW**

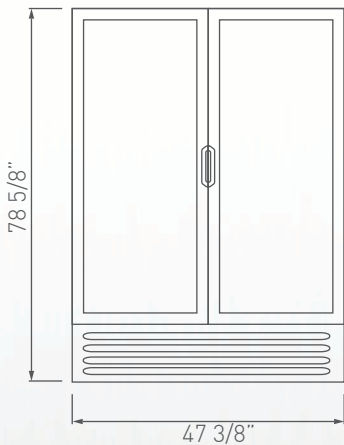

**FRONT VIEW**

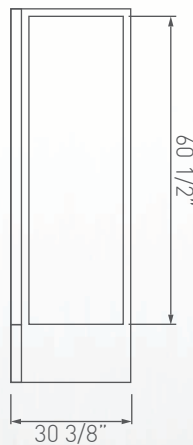

**SIDE VIEW**

### Warranty:

Three year limited warranty on all parts and labor, an additional two year warranty on compressor. (USA and Canada only)

Dimensions rounded up to the nearest inch or millimeter.  
Specifications subject to change without notice.

Customer Service: 866-363-0079 | [WWW.IMBERAFOODSERVICE.COM](http://WWW.IMBERAFOODSERVICE.COM)

## TECHNICAL SPECIFICATIONS

Exterior Dimensions	W:	47 3/8"	1203 mm
	D:	30 3/8"	770 mm
	H:	78 5/8"	1997 mm

Interior Dimensions	W:	43 1/8"	1095 mm
	D:	25 3/4"	652 mm
	H:	60 1/2"	1537 mm

Dimensions w/packaging	W:	49 1/2"	1258 mm
	D:	32"	813 mm
	H:	82 1/2"	2097 mm

Shelf Size	W:	20 1/2"	520 mm
	D:	20 5/8"	524 mm

<b>Weight</b>	434.3 Lbs	197.0 kg
<b>Weight w/packaging</b>	453.0 Lbs	205.5 kg

<b>Shelves</b>	10
----------------	----

<b>Capacity 20oz.</b>	<b>Flat:</b>	490
	<b>Gravity:</b>	420

## REFRIGERATION DATA

<b>Energy Consumption</b>	5.170 kWh/day
---------------------------	---------------

<b>Voltage</b>	115/60
----------------	--------

<b>Horse Power</b>	1/2
--------------------	-----

<b>AMPS</b>	10.0
-------------	------

## LOGISTIC

<b>Trailer Loads</b>	40':	24
	53':	31

<b>Certifications</b>	UL:	✓
	ES:	✓
	UL/EPH:	✓

\* Energy consumption based on ANSI/ASHRAE Standard 72-2005.

BMAD System (Low maintenance high performance).  
Dimensions rounded up to the nearest inch or millimeter.  
Specifications subject to change without notice.