

To better help you obtain assistance or service should you ever need it, write down the following information about the product. This information is on the identification label located on the left hand inside wall of the cabinet. We advise you to keep this Owners Manual and sales slip in your possession.

Model: \_\_\_\_\_

Serial Number: \_\_\_\_\_

Date of Purchase: \_\_\_\_\_



# Owners Manual

## High Visibility Glass Door

## Refrigerators

### Double Door Models

43-UDGR-VX, 43-UDGR-V0, 43-UDGR-VF

43X-UDGR-VX, 43X-UDGR-V0

21X-UDGR-VX, 21X-UDGR-V0

20X-UDGR-VX, 20X-UDGR-V0

18Z-UDGR-VX, 18Z-UDGR-V0



30 Armstrong Avenue  
Georgetown, Ontario  
Canada L7G 4R9

tel: 800.800.5706 or 905.702.1441  
fax: 905.702.1442  
email: [info@duenorth.com](mailto:info@duenorth.com)  
web: [duenorth.com](http://duenorth.com)

Part No. 104068

MNL\_R290\_UDGR-VX-V0-VF\_EN20240701



30 Armstrong Ave. Georgetown, Ontario Canada L7G 4R9  
tel 800.800.5706 • 905.702.1441 • fax 905.702.1442 • [DUENORTH.com](http://DUENORTH.com)

# ILLUSTRATION 18Z-UDGR, 43-43X-UDGR

Model 43-UDGR-VF comes with full height doors without lighted display assembly (Items 1, 2).

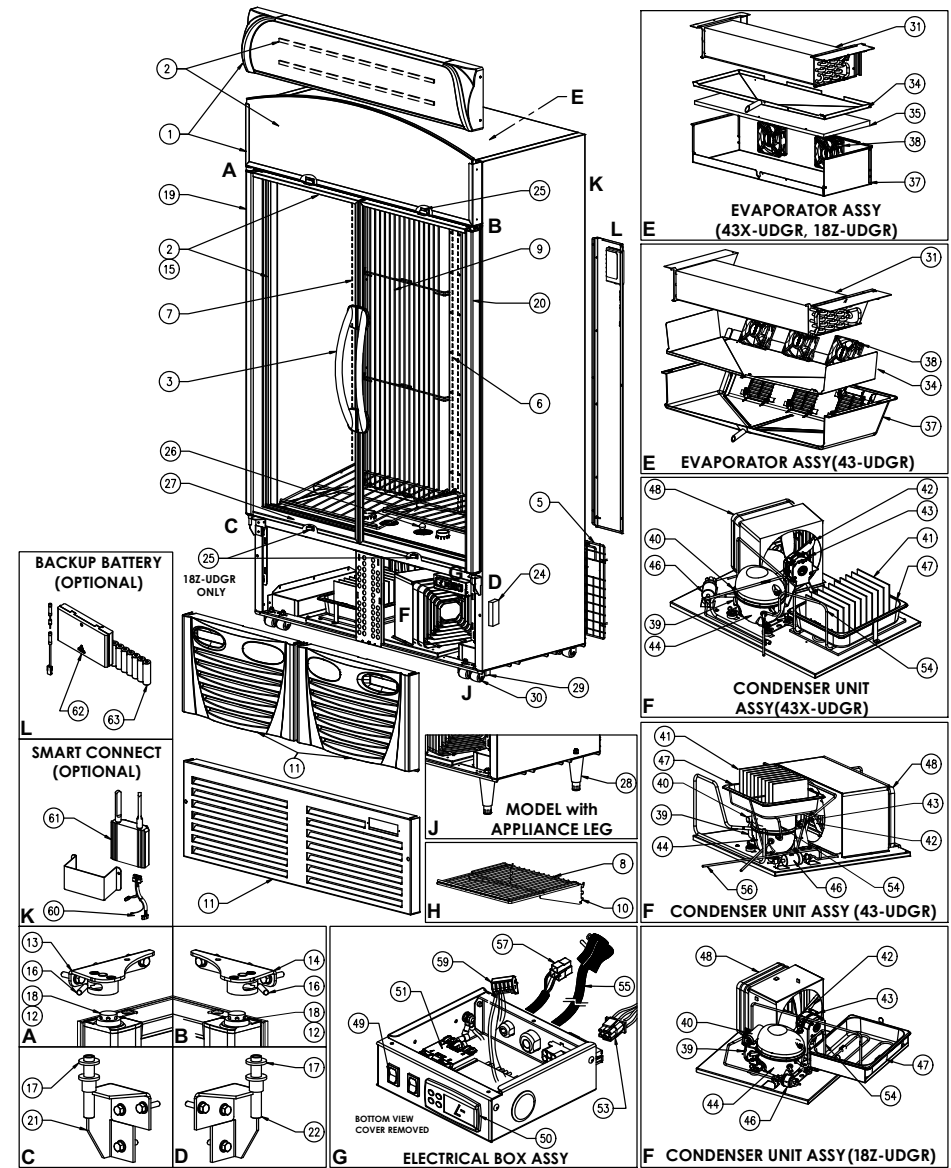

## ILLUSTRATION 21X-UDGR

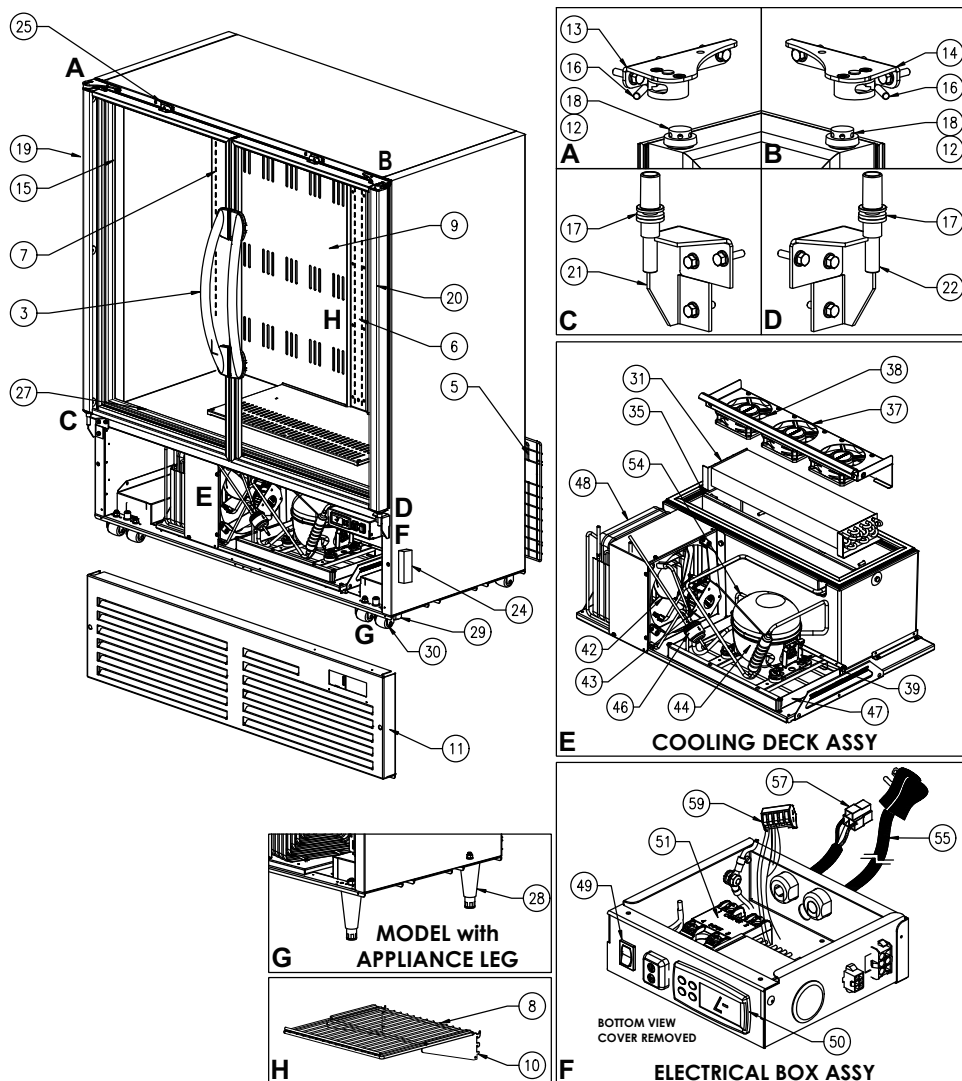

### ⚠ WARNING

MAKE SURE THE REFRIGERATOR IS DISCONNECTED FROM THE POWER SUPPLY BEFORE ANY SERVICE. PRESS THE REFRIGERATOR SWITCH TO THE "OFF" POSITION THEN UNPLUG THE POWER CORD FROM THE ELECTRICAL RECEPTACLE.

ALL SERVICE WORK MUST BE PERFORMED BY CERTIFIED, FACTORY AUTHORIZED SERVICE PERSONNEL ONLY. COMPONENT PARTS MUST BE REPLACED WITH LIKE COMPONENTS.

COMMERCIAL USE ONLY. NOT FOR HOUSEHOLD USE.

FOR INDOOR USE ONLY.

### ⚠ SAFETY PRECAUTIONS

READ ALL INSTRUCTIONS AND SAVE THESE INSTRUCTIONS FOR FUTURE REFERENCE.

DO NOT STORE OR USE GASOLINE OR OTHER FLAMMABLE VAPORS AND LIQUIDS NEAR THIS OR ANY OTHER APPLIANCE.

DO NOT TOUCH COLD SURFACES WITH DAMP OR WET HANDS. SKIN MAY STICK TO EXTREMELY COLD SURFACES.

DO NOT ALLOW CHILDREN TO CLIMB, HANG OR STAND ON REFRIGERATOR SHELVES.

KEEP FINGERS OUT OF PINCH-POINT AREAS.

DISCONNECT POWER TO THE UNIT PRIOR TO CLEANING OR REPAIRING.

BEFORE DISCARDING THIS OR ANY OTHER APPLIANCE, REMOVE THE DOORS OR LIDS TO REDUCE RISK OF CHILD ENTRAPMENT.

WHEN RECYCLING THE UNIT, REFRIGERANTS MUST BE HANDLED IN ACCORDANCE WITH LOCAL AND NATIONAL REGULATIONS.

### NOTICE

ALL MODELS ARE CERTIFIED FOR USE WITH BOTH POTENTIALLY HAZARDOUS AND NON-POTENTIALLY HAZARDOUS PACKAGED FOODS.

### NOTICE

OPERATING THE REFRIGERATOR FOR 24 HOURS PRIOR TO LOADING PRODUCT IS RECOMMENDED

MONITOR REFRIGERATOR TEMPERATURE REGULARLY

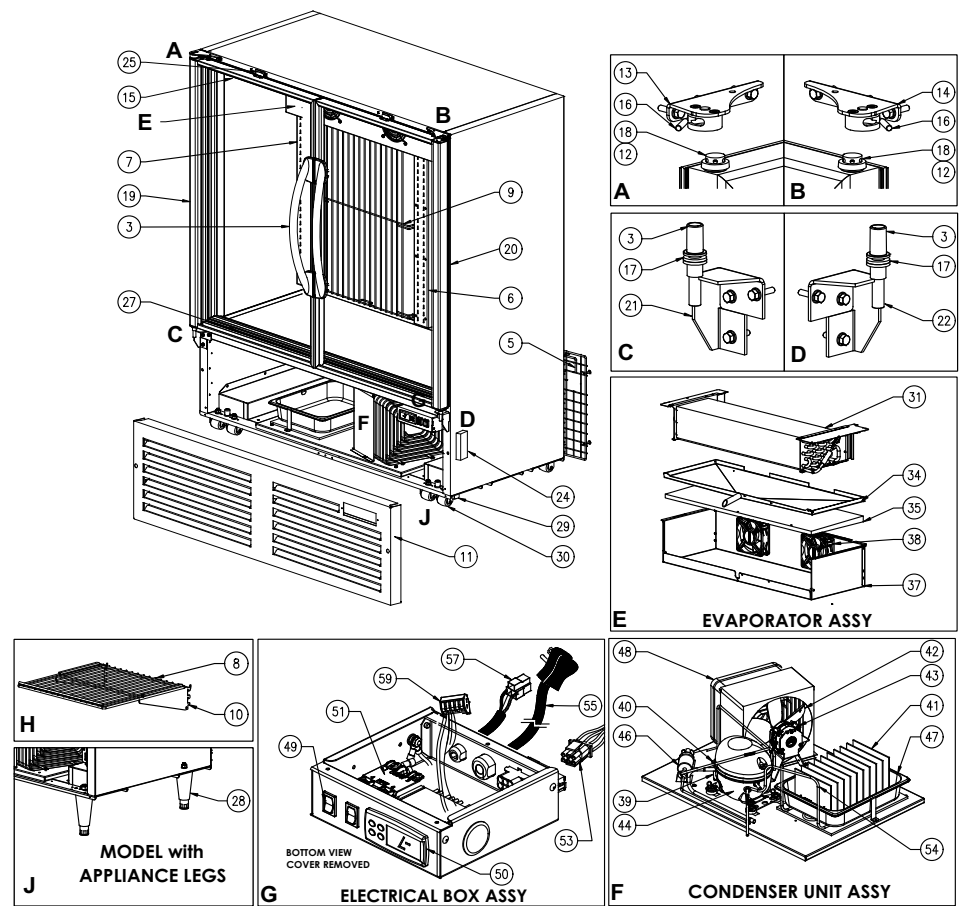

## PARTS LIST

No	Description	No	Description
1	Top Display Assembly(Metal or Plastic Molded) (18Z-UDGR, 43/43X-UDGR-VX,VO only)	33	not used
2	Header LED Light Panel or LED Strips (18Z-UDGR, 43/43X-UDGR-VX,VO only)	34	Evaporator Tray
3	Handle Assembly-HV/UV-Bowed	35	Evaporator Styrofoam Pad
4	not used	36	not used
5	Rear Grill	37	Evaporator Shroud
6	Post, Cantilever-Centre	38	Evaporator Fan
7	Post, Cantilever-Sides	39	PTC Relay
8	Shelf	40	Run Capacitor
9	Interior Back Grill	41	Wicking Pad (Optional)
10	Bracket, Cantilever	42	Fan Blade(Condensing Unit)
11	Front Bottom Grill (Metal or Molded)	43	Fan Motor(Condensing Unit)
12	Torsion Shaft (c/w Door)	44	Compressor
13	Door Top Bracket (Left)	45	not used
14	Door Top Bracket (Right)	46	Filter Drier
15	Heater Breaker Seal LED	47	Condensate Tray
16	Torsion Pin	48	Condenser Coil
17	Nylon Washer	49	Rocker Switch
18	Torsion Bar (c/w Door)	50	Controller
19	Door Assembly (Left)	51	Compressor Relay
20	Door Assembly (Right)	52	not used
21	Door Bottom Bracket (Left)	53	Evaporator Fan Wires
22	Door Bottom Bracket (Right)	54	Compressor Discharge Line
23	not used	55	Power Cord
24	LED Driver	56	Liquid Header
25	Door Switch	57	Compressor Harness
26	Pressure Relief Ball (43-UDGR only)	58	not used
27	not used	59	5 Pole Terminal Block
28	Appliance Leg (Optional)	60	Gateway Wire Harness (Optional)
29	Leveling Leg	61	Gateway, IOT-LTE-NA (Optional)
30	Caster	62	Battery Holder (Optional)
31	Evaporator Coil	63	Backup Battery (Optional)
32	not used	64	not used

## CAUTIONARY INSTRUCTIONS FOR UNITS CHARGED WITH PROPANE (R290) REFRIGERANT

### ⚠ WARNING



**THIS UNIT IS CHARGED WITH PROPANE REFRIGERANT. PROPANE IS AN EXTREMELY FLAMMABLE AND EXPLOSIVE GAS. PLEASE READ CAREFULLY THIS MANUAL/GUIDE AND FOLLOW ALL SAFETY PRECAUTIONS CONTAINED HEREIN TO REDUCE A RISK OF FIRE AND/OR EXPLOSION. FAILURE TO FOLLOW THE SAFETY PRECAUTIONS MAY RESULT IN SERIOUS INJURY OR DEATH, AND/OR PROPERTY DAMAGE.**

- **DANGER - RISK OF FIRE OR EXPLOSION. FLAMMABLE REFRIGERANT USED. DO NOT USE MECHANICAL DEVICES TO DEFROST REFRIGERATOR. DO NOT PUNCTURE REFRIGERANT TUBING.**
- **DANGER - RISK OF FIRE OR EXPLOSION. FLAMMABLE REFRIGERANT USED. TO BE REPAIRED ONLY BY FACTORY AUTHORIZED TRAINED SERVICE PERSONNEL. DO NOT PUNCTURE REFRIGERANT TUBING.**
- **CAUTION - RISK OF FIRE OR EXPLOSION. FLAMMABLE REFRIGERANT USED. CONSULT REPAIR MANUAL/OWNER'S GUIDE BEFORE ATTEMPTING TO SERVICE THIS PRODUCT. ALL SAFETY PRECAUTIONS MUST BE FOLLOWED.**
- **CAUTION - RISK OF FIRE OR EXPLOSION. DISPOSE OF PROPERLY IN ACCORDANCE WITH FEDERAL OR LOCAL REGULATIONS. FLAMMABLE REFRIGERANT USED.**
- **CAUTION - RISK OF FIRE OR EXPLOSION DUE TO PUNCTURE OF REFRIGERANT TUBING; FOLLOW HANDLING INSTRUCTIONS CAREFULLY. FLAMMABLE REFRIGERANT USED.**

Propane is approved for use as a refrigerant in commercial, self-contained units in Canada and USA under limited use conditions. It can be used in new equipment only, retrofitting is not allowed, with a limited charge of up to 150 grams (5.3 oz) per refrigeration circuit. Even though this is a small amount, it still presents a fire/explosion hazard if it leaks out of refrigerant containing parts. When mixed with air, a flammable propane-air mixture can be created and easily ignited by sparks, open flames, or hot surfaces. This is particularly true in confined zones. Propane is heavier than air and tends to settle at lower points.

To mitigate the risk, please follow the precautionary measures as follows:

- Avoid unit installation in areas with open flames (kitchens, repair garages or the like), or in vicinity of open flames or high surface temperatures.
- Avoid unit installation in confined spaces. Well ventilated areas are preferred. Keep clear all ventilation openings of obstructions.
- Do not rely on smell to detect potential leaks of propane refrigerant. Propane refrigerant is a high purity propane gas and does not contain any stenching agent(s). Stenching agents are typically used in fuel-grade propane and natural gas to detect their presence in air by relying on smell.
- All repairs must be performed in well ventilated areas.
- To minimize the risk of possible ignition due to incorrect parts or improper service, component parts shall be replaced with like components and servicing shall be done by service personnel authorized by Minus Forty Technologies.
- Do not attempt to modify the unit or remove any functional part(s) from the unit.
- Handle the unit with care to avoid any damage.
- When transporting the unit, all appropriate safety considerations must be considered. Check with local Department of Transportation for detailed requirements pertaining to transportation of flammable gasses.

# CONTENTS

Warranty	1
Installation Instructions	2
Power Requirements	2
Cantilever Shelf Installation and Adjustment	3 - 4
Operating Instructions	5
Product Loading	6
Temperature Adjustment and Switch Functions	7
Controller Alarms and Signals	7 - 8
Controller Symbols and Functions	8
Condenser Cleaning	9
Cabinet Cleaning	9 - 10
How to Remove the Front Bottom Grill	10
Interior LED Strip Replacement	11
ISD Trans-Light LED Panel Replacement	12
ISD Trans-Light LED Strip Replacement	13 - 14
Trans-Light Graphic Panel Replacement	14
Troubleshooting Guide	15 - 16
Wiring Diagram	17
Parts List	18
Illustration (20X-UDGR)	19
Illustration (21X-UDGR)	20
Illustration (18Z-UDGR, 43-UDGR, 43X-UDGR)	21

# WIRING DIAGRAM

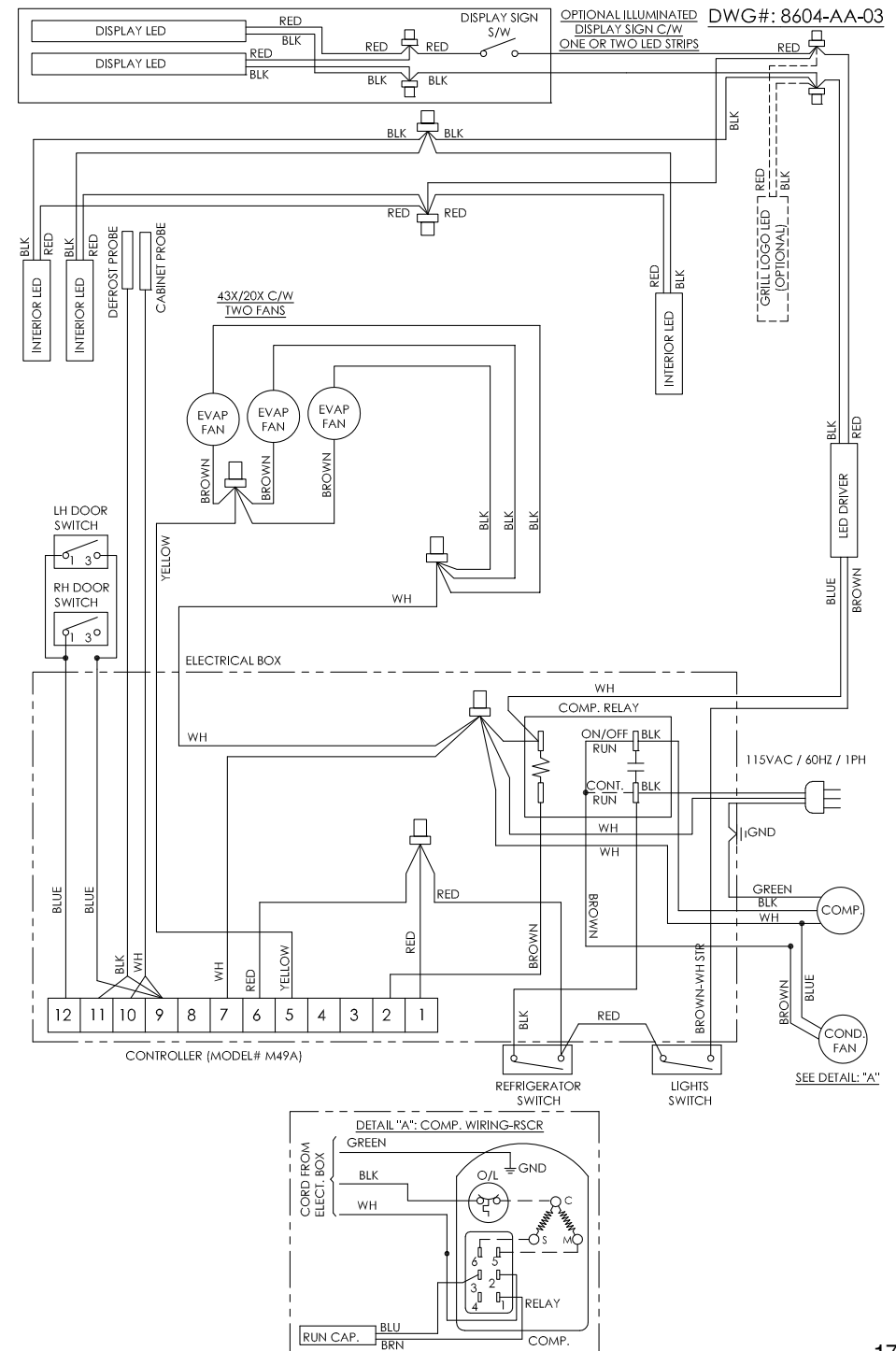

## TROUBLESHOOTING GUIDE CONT'D

for online reference go to [duenorth.com](http://duenorth.com)

### **WARNING**

Make sure the refrigerator is disconnected from the power supply before any service. Press the refrigerator switch to the "Off" position then unplug the power cord from electrical receptacle. All service work must be conducted by a certified technician only.

Problem	Possible Cause	Action
Condensation on glass door.	<ul style="list-style-type: none"> <li>• Door not closing properly.</li> <li>• Room humidity too high.</li> </ul>	<ul style="list-style-type: none"> <li>• Check the spring tension or any obstruction</li> <li>• To prevent condensation, room humidity should be below 55%.</li> </ul>
LED strips are not working.	<ul style="list-style-type: none"> <li>• Light switch is off.</li> <li>• Faulty LED strip.</li> </ul>	<ul style="list-style-type: none"> <li>• Check if the light switch is on.</li> <li>• Replace the LED strip. (See page 11, 13)</li> </ul>
Cabinet is noisy.	<ul style="list-style-type: none"> <li>• Part(s) loose</li> <li>• Tubing vibrating</li> </ul>	<ul style="list-style-type: none"> <li>• Locate and tighten loose part(s).</li> <li>• Ensure tubing is not in contact with other tubing or components.</li> </ul>
Door does not close tight.	<ul style="list-style-type: none"> <li>• Refrigerator is not leveled.</li> <li>• Hinges are loose / not adjusted.</li> <li>• Gasket is out of the groove.</li> </ul>	<ul style="list-style-type: none"> <li>• Level the unit (See page 2).</li> <li>• Adjust / tighten the hinge screws.</li> <li>• Check gasket condition. Adjust position or replace gasket.</li> </ul>
Electronic control blank, flashing, or displaying incorrect characters.	<ul style="list-style-type: none"> <li>• Wires disconnected at back of electronic control.</li> </ul>	<ul style="list-style-type: none"> <li>• See actions described in the controller section. (pages 7-8)</li> </ul>
Evaporator fan does not run.	<ul style="list-style-type: none"> <li>• Fan wire disconnected.</li> <li>• Door switch not working.</li> </ul>	<ul style="list-style-type: none"> <li>• Check wiring.</li> <li>• Check door switch.</li> </ul>
Water on the floor coming from the condensate pan.	<ul style="list-style-type: none"> <li>• High humidity.</li> <li>• Excessive door openings.</li> <li>• Clogged wicking pads.</li> </ul>	<ul style="list-style-type: none"> <li>• Room humidity should be below 55%.</li> <li>• Consider installing an additional cooler.</li> <li>• Replace wicking pads.</li> </ul>

## STANDARD WARRANTY FOR MINUS FORTY® REFRIGERATION EQUIPMENT AND ACCESSORIES

### LIMITED WARRANTY

Minus Forty® Technologies warrants its products to be free from defect as to workmanship and materials for a period of twelve (12) months from the time of delivery.

Minus Forty® Technologies will at its option either replace or repair any defective parts returned within twelve (12) months of the time of delivery, transportation charges prepaid, which Minus Forty® Technologies in its sole discretion, determines to be defective.

This warranty shall not apply to any products that have been repaired or altered outside of Minus Forty® Technologies factory or repair facilities if the repairs in the judgement of Minus Forty® Technologies have affected the reliability or wear of the product and nor does the guarantee apply to any product which has been subject to misuse, accident or to any product which has not been maintained pursuant to the instruction of Minus Forty® Technologies.

This warranty does not extend to any consequential damage caused by the failure of the product under any circumstance and further, Minus Forty® Technologies shall not be responsible for damage to the contents of the product or any economic loss caused by the failure of the product, whether such loss is suffered by the customer or a third party user of the product or whether the contents are owned by the customer or a third party user or supplier.



Effective January 1, 1996

## INSTALLATION INSTRUCTIONS

### ⚠ WARNING

These refrigerators **MUST** be installed on a dedicated grounded circuit protected with a 15 Amp circuit breaker or a 15 Amp fuse. Do not remove ground prong. If the cord or plug is damaged, replace with the same type. Refrigeration and electrical work must be performed by a qualified technician. Failure to follow these instructions can result in injury, death, fire, or electrical shock.

### POWER REQUIREMENTS:

All models require a 15 Amp dedicated and properly grounded 115V/60Hz/1Ph circuit with a NEMA 5-15P receptacle. Wiring should be sized according to the amperage rating stated on the serial plate. Failure to use a dedicated circuit may cause the circuit breaker to trip off and/or cause voltage drops. As a result, power to the refrigerator may be interrupted and cooling performance can be adversely affected which may cause equipment damage and/or product loss.



Voltage supply to the refrigerator must not vary more than  $\pm 10\%$  of the nominal 115V, or performance may be affected. The warranty and liability does not cover damage resulting from excessive voltage variations.

- DO NOT USE AN EXTENSION CORD
- DO NOT CUT, REMOVE OR BYPASS THE GROUNDING PRONG FROM THE PLUG
- DO NOT PLUG REFRIGERATOR INTO AN OUTLET CONTROLLED BY A WALL SWITCH
- ENSURE POWER CORD IS NOT CUT OR DAMAGED FROM PINCHING, KNOTTING, OR MISHANDLING

**CABINET LOCATION:** An air space of at least 1" (2.5cm) must be maintained on all sides of the refrigerator. Do not locate the refrigerator in a warm unventilated room exceeding 86°F (30°C) and 55%RH; do not place refrigerator in direct sunlight; do not place refrigerator under or near heat range or heating vent.

**CABINET LEVELING:** The refrigerator must be completely leveled side to side and front to back or slightly tilted front to back but never tilted forward. Once the refrigerator is placed in its final location, use a carpenter level to level the refrigerator. Proper leveling of the refrigerator is important for the door closing and water drainage during the defrost cycle. There are two leg levelers in the front that can be adjusted. First, loosen the nuts using an adjustable wrench. Second, turn levelers counter-clockwise to raise the refrigerator, or clockwise to lower, until they reach the leveled position. Lastly, tighten the nuts again to lock the legs.

### NOTICE:

Failure to follow these instructions may void the warranty and/or cause loss of product.

## TROUBLESHOOTING GUIDE

for online reference go to [duenorth.com](http://duenorth.com)

### ⚠ WARNING

Make sure the refrigerator is disconnected from the power supply before any service. Press the refrigerator switch to the "Off" position then unplug the power cord from electrical receptacle. All service work must be conducted by a certified technician only.

Problem	Possible Cause	Action
Refrigerator not operating.	<ul style="list-style-type: none"> <li>• Refrigerator switch located on the front grill turned off.</li> <li>• Fuse blown / circuit breaker tripped.</li> <li>• Power cord unplugged.</li> <li>• Receptacle not working.</li> <li>• Improper voltage supplied to cabinet / over load circuit.</li> </ul>	<ul style="list-style-type: none"> <li>• Turn power switch on.</li> <li>• Replace fuse/reset circuit breaker.</li> <li>• Plug in power cord.</li> <li>• Check receptacle.</li> <li>• Remove extension cords or other equipment on the same circuit.</li> </ul>
Refrigerator not getting cold but compressor is operating.	<ul style="list-style-type: none"> <li>• Refrigerator located in direct sunlight or ambient (room) temperature is too hot.</li> <li>• Condenser clogged with dust.</li> </ul>	<ul style="list-style-type: none"> <li>• Move refrigerator away from direct sunlight.</li> <li>• Room temperature is recommended not to exceed 86°F (30°C), 55% RH.</li> <li>• See page 9 (Cleaning)</li> </ul>
Condensing unit operating for a prolonged period or continuously.	<ul style="list-style-type: none"> <li>• Refrigerator loaded with excessive amount of warm product.</li> <li>• Prolonged door opening or door ajar.</li> <li>• Door not closing properly.</li> <li>• Clogged condenser.</li> </ul>	<ul style="list-style-type: none"> <li>• Allow enough time for product to cool down.</li> <li>• Close door when not in use. Avoid prolonged door openings.</li> <li>• Level the unit (See page 2). Check gasket condition. Check the door spring.</li> <li>• Clean the condenser (See page 9).</li> </ul>
Refrigerator cabinet temperature too high.	<ul style="list-style-type: none"> <li>• Electronic control set too high.</li> <li>• Poor air circulation in cabinet.</li> <li>• Insufficient clearance around cabinet or ambient temperature too high.</li> <li>• Clogged condenser</li> </ul>	<ul style="list-style-type: none"> <li>• Adjust control setting (See page 7).</li> <li>• Follow instructions for product loading (See page 6)</li> <li>• Keep at least 1" (2.5cm) free space around all sides of the refrigerator. Room temperature is recommended not to exceed 86°F (30°C), 55% RH. Make sure the air flow to the compressor is not obstructed.</li> <li>• Clean the condenser (See page 9)</li> </ul>



## ISD TRANS-LIGHT LED STRIP REPLACEMENT CONT'D

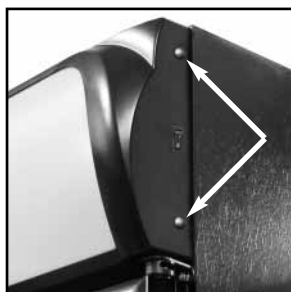

Replace the plastic screw covers on the display end cap.



Plug the refrigerator in and make sure the light switch on the bottom grill is in the 'ON' position.



Ensure the display light switch is in the 'ON' position.

## GRAPHIC PANEL REPLACEMENT (IF EQUIPPED)

### ⚠ WARNING

Make sure the refrigerator is disconnected from the power supply before any service. Press the refrigerator switch to the "Off" position then unplug the power cord from electrical receptacle. All service work must be conducted by a certified technician only.

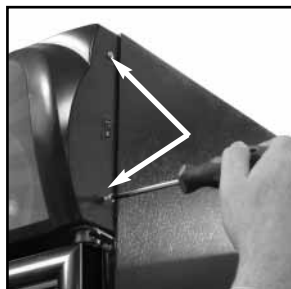

Remove the two plastic screw covers and the two screws from the right hand display end cap.

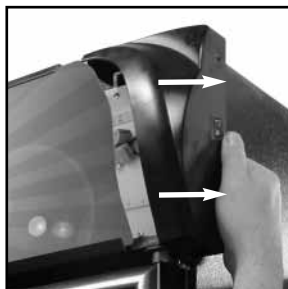

Slide the right hand display end cap from the display frame.



Slide out the old panel and replace with the new panel.

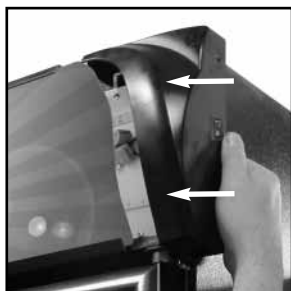

Replace the display end cap.

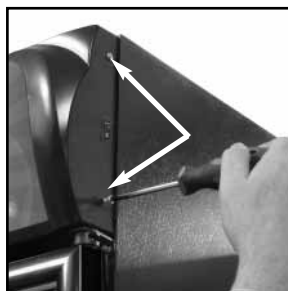

Replace the two screws and plastic screw covers on the display end cap. Ensure the display light switch is in the 'ON' position.



Plug the refrigerator in and make sure the light switch on the bottom grill is in the 'ON' position.

## CANTILEVER SHELF INSTALLATION AND ADJUSTMENT

Models: 43X-UDGR-VX, 43X-UDGR-V0, 21X-UDGR-VX, 21X-UDGR-V0, 20X-UDGR-VX, 20X-UDGR-V0, 18Z-UDGR-VX, 18Z-UDGR-V0

Follow these steps for shelving assembly and installation:

1. On the left side of the shelf, install one cantilever bracket on the outer frame.

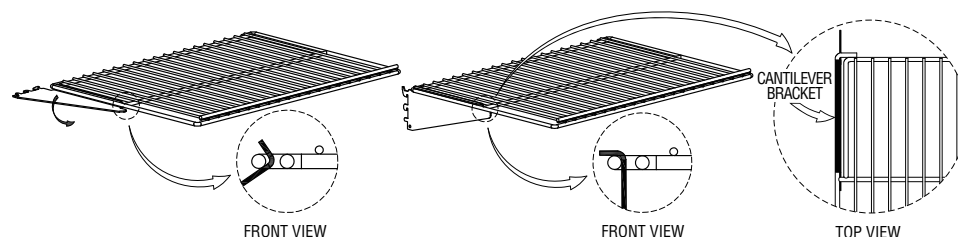

2. On the right side of the shelf, install one cantilever bracket on the inner frame.

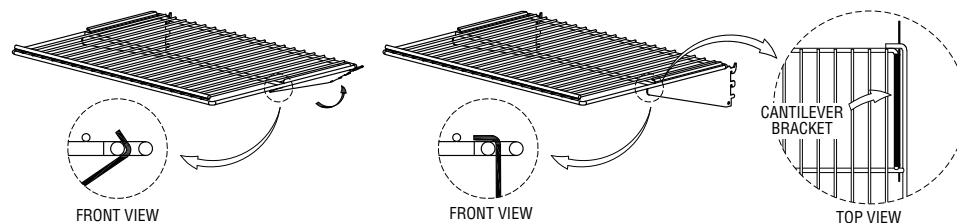

3. Hold shelf/bracket assembly with both hands and slide into desired slots on the posts at the back of the unit.

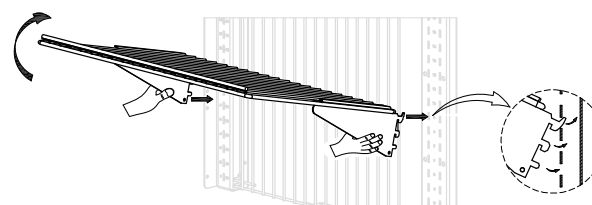

Then, push the assembly down to secure in place.

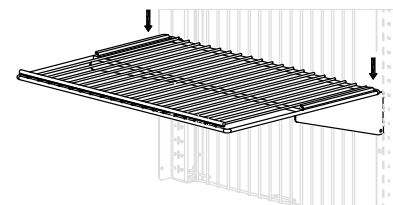

4. Install the remaining brackets and shelves following the same steps above at the desired shelf positions.

## CANTILEVER SHELF INSTALLATION AND ADJUSTMENT

Models: 43-UDGR-VX, 43-UDGR-V0, 43-UDGR-VF

Follow these steps for shelving assembly and installation:

1. On the left side of the shelf, install one cantilever bracket on the outer frame.

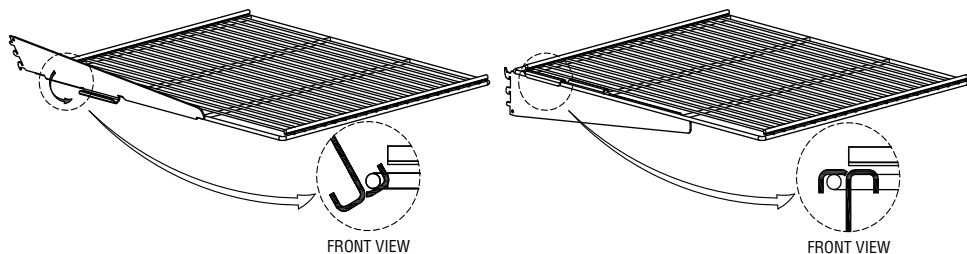

2. On the right side of the shelf, install one cantilever bracket on the outer frame.

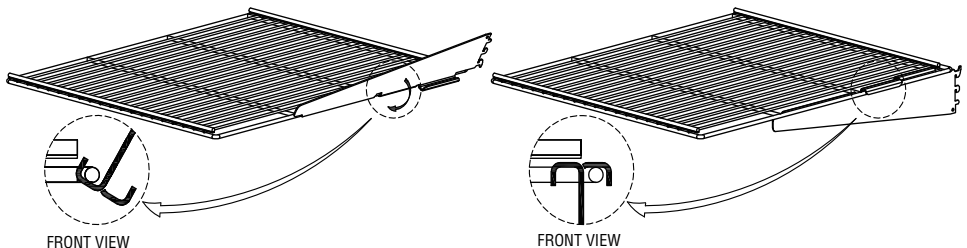

3. Hold shelf/bracket assembly with both hands and slide into desired slots on posts at the back of the unit.

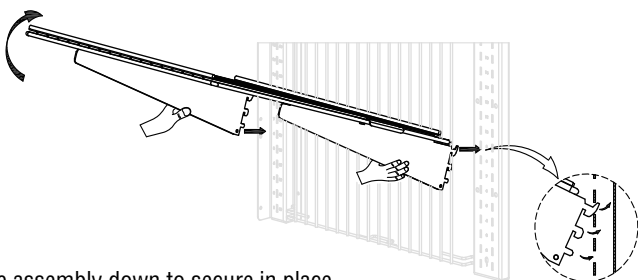

Then, push the assembly down to secure in place.

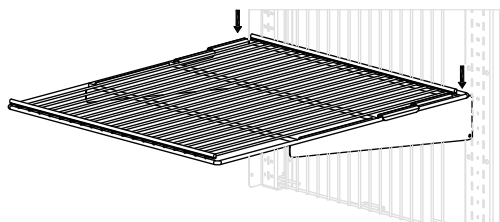

4. Install the remaining side brackets and shelves following the same steps above at the desired shelf heights.

## ISD TRANS-LIGHT LED STRIP REPLACEMENT (IF EQUIPPED)

### ⚠ WARNING

Make sure the refrigerator is disconnected from the power supply before any service. Press the refrigerator switch to the "Off" position then unplug the power cord from electrical receptacle. All service work must be conducted by a certified technician only.

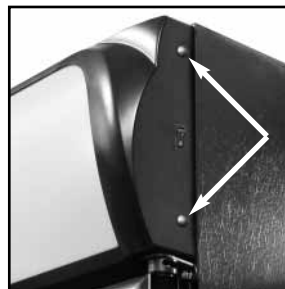

Remove the plastic screw covers from the right hand side of the display.



With a screwdriver remove the two screws from the right hand side of the display.

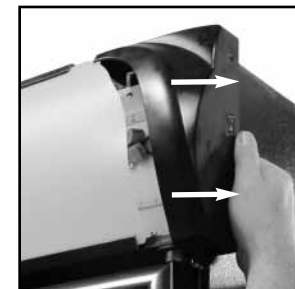

Slide the right hand display end cap from the display frame.

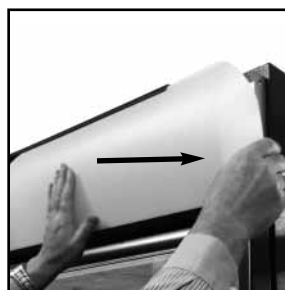

Slide the diffuser panel and graphic panel (if used) out of the frame channel.



Disconnect LED strip wires from connectors and peel LED strips off refrigerator.



Install replacement LED strips at the same place and connect wires. Observe color coding.

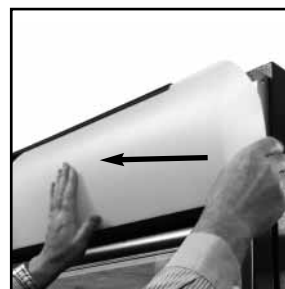

Replace the diffuser panel and graphic panel (if used).

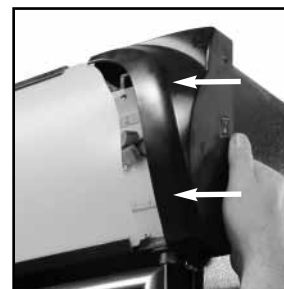

Replace the display end cap.



Replace the two screws on the display end cap.

## ISD TRANS-LIGHT LED PANEL REPLACEMENT (IF EQUIPPED)

### ⚠ WARNING

Make sure the refrigerator is disconnected from the power supply before any service. Press the refrigerator switch to the "Off" position then unplug the power cord from electrical receptacle. All service work must be conducted by a certified technician only.

**NOTE:** Rectangular LED panel shown. For arched LED panel, follow the same steps.

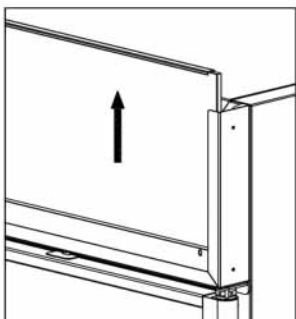

Lift up the LED panel assembly and remove it from the holding frame.

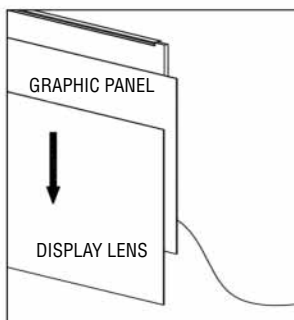

Slide down the display lens (clear plastic) and the printed graphic panel (if equipped).

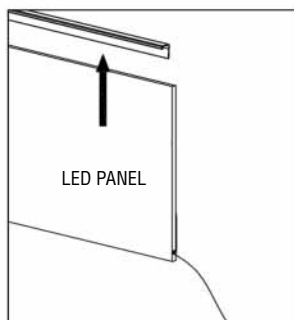

Peel off the aluminum tape at the back of the LED light panel and remove the top extrusion.

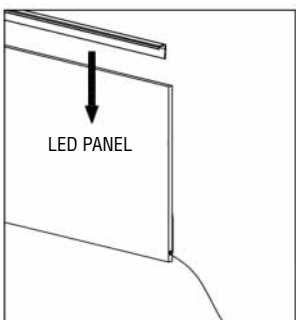

Install the top extrusion onto the replacement / new LED Panel.

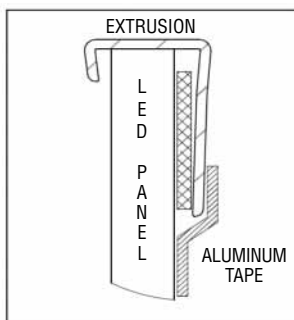

Apply aluminum tape at the back by overlapping both the top extrusion and LED panel.

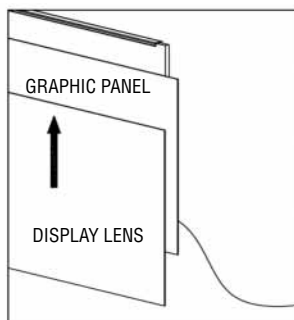

Re-install the display lens (clear plastic) and the printed graphic panel (if equipped) into the top extrusion.

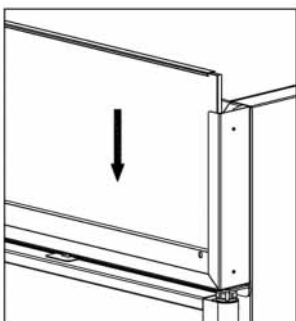

Slide the LED panel assembly down into the holding frame.

## OPERATING INSTRUCTIONS

### ⚠ WARNING

Check with your power company if you are not certain of your power supply. Before connecting to power supply the refrigerator should be upright and idle for at least 1 hour.

Once the unit has been installed and the power supply has been connected, press the power switch to the "ON" position using a pen or pencil.

The compressor will start to run after 6 minutes. This can be confirmed by listening for a slight humming or a slight vibration.



### NOTE:

If the refrigerator is running and the power supply is interrupted, the refrigerator will not restart immediately. There is a 6 minute delay for compressor protection.

Once the refrigerator is running, the inside temperature will start to cool down within a couple of minutes. Ensure that the refrigerator has reached the desired temperature (this will take between 2 to 3 hours) by checking the electronic control display readout before loading product.

**It is strongly recommended to run the refrigerator empty for 24 hours before loading any products.**

## PRODUCT LOADING

### NOTICE:

Ensure the refrigerator has reached the proper operating temperature before loading product. The electronic control displays the interior cabinet temperature.

Product loss is not covered under warranty.

For enhanced performance of the unit and to avoid spoilage of perishable products, follow these instructions:

18Z/43/43X-UDGR  
43-UDGR-VF uses full height doors without display assembly.



**DO NOT** stock any products against the evaporator fans. See load limit labels inside the cabinet for reference.

**DO NOT** block the air space behind the grill. Free space is required for proper air circulation.

**DO NOT** overstock the unit.

21X-UDGR



**DO NOT** stock any products above the top load limit label. This space is required for proper air circulation. See load limit labels inside the cabinet for reference.

**DO NOT** block the air vents on the back grill. Free space is required for proper air circulation.

**DO NOT** overstock the unit.

20X-UDGR



**DO NOT** stock any products against the evaporator fans. See load limit labels inside the cabinet for reference.

**DO NOT** block the air space behind the grill. Free space is required for proper air circulation.

**DO NOT** overstock the unit.

## INTERIOR LED STRIP REPLACEMENT

### WARNING

Make sure the unit is disconnected from the power supply before any service. Press the power switch to the "Off" position then unplug the power cord from electrical receptacle. All service work must be conducted by a certified technician only.



Remove silicone corner beads. Pry the screwdriver between plastic cover and cabinet frame. Pry from one end to the other.

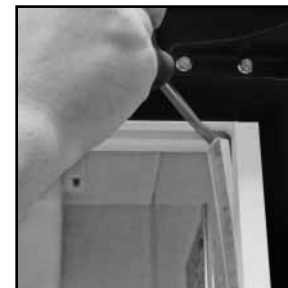

Pry the screwdriver between plastic lens cover and cabinet frame.



Carefully remove the plastic lens cover from cabinet frame.

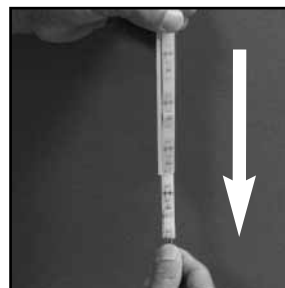

Slide faulty LED strip from plastic cover.



Locate the wire for the LED strip in the compressor compartment and disconnect from connectors.

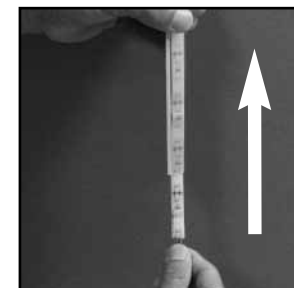

Install the new LED strip into the plastic cover.



Attach wires, observing color coding. Press lens cover back to cabinet frame.



Snap plastic cover back to cabinet frame. Apply silicone at plastic cover corners.



Plug the unit in and make sure the light switch on the bottom grill is in the 'ON' position.

## CABINET CLEANING (CONT'D)

### EXTERIOR CLEANING

Use only mild non-abrasive liquid cleaner, water and a soft cloth for the painted surfaces and a stainless steel polish and cleaner for the stainless steel surfaces if desired.

### CLEANING GLASS DOOR EXTERIOR

Due to the special coating on the glass, use only a mild, non-abrasive liquid cleaner, water, and a soft cloth. The same applies to the plastic door frame.

## HOW TO REMOVE THE FRONT BOTTOM GRILL



With a screwdriver remove the bottom screws from the grill.

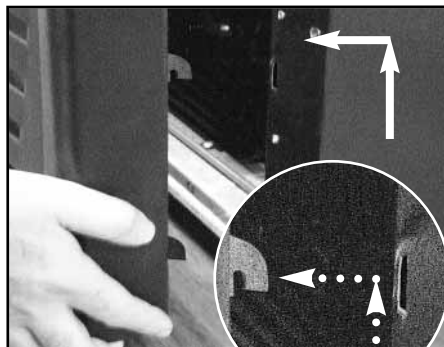

Grasp the bottom grill from the sides and slide it up and towards you to release the hooks.

To replace bottom grill, align hooks of the grill with slots and slide the grill back onto the refrigerator. Replace the bottom screws to secure the grill to the cabinet.

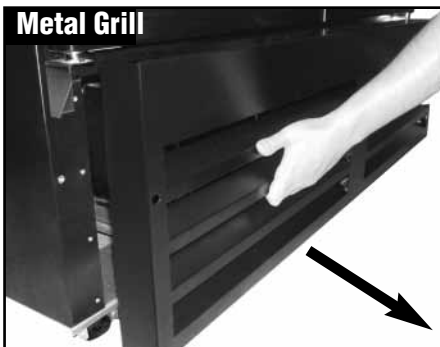

With a screwdriver, remove the two screws and washers from the grill front. Grasp the grill behind ventilation slots as shown, and pull it towards you.

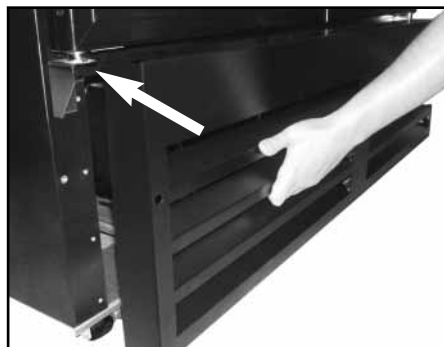

To replace bottom grill, align the hinge slots in the grill with the hinge pins and push the grill back. Replace the screws and washers to secure the grill to the cabinet.

## TEMPERATURE ADJUSTMENT AND SWITCH FUNCTIONS

Locate the electronic control on the right of the front bottom grill. The electronic control displays actual temperature inside the refrigerator. In addition, the electronic control turns the refrigeration system OFF when refrigerator reaches the set temperature, and turns the refrigeration system ON after the refrigerator temperature rises by 5°F or after 7 minutes, whichever lasts longer.

To adjust the set temperature, follow these steps:

1. Press and release P button; the set temperature and SP1 are displayed alternatively on the controller
2. Press the UP or DOWN buttons to adjust the set temperature.
3. Press P to store the adjusted value; The electronic control will return to cabinet temperature display. The U Button on the electronic controller is used for displaying cabinet and defrost temperatures (PR1 and PR2 parameters)

There are two switches located on the right hand side of the controller.

Their functions are to manually switch electronic components of the refrigerator.

1. POWER switch turns the refrigeration system (including all electrical parts) ON or OFF. (use a pen or pencil to press the power switch to the ON or OFF position).
2. LIGHT switch turns the internal and external lights ON or OFF.

### ELECTRONIC CONTROLLER



ELECTRONIC CONTROL

POWER

LIGHTS

## CONTROLLER ALARMS AND SIGNALS

The electronic controller can detect and signal several alarm conditions: high/low refrigerator temperatures, door open and open or short-circuited temperature probes. If the alarm conditions last longer than pre-programmed time delays, the controller will turn ON an audio signal (buzzer). Also a LED light located in the upper left corner of the controller, next to the caution symbol, will glow in case an alarm is active.

Once the alarm conditions have been fixed, the controller will turn off the alarms on its own. Alarms can be disabled by pressing any controller button, during alarm conditions

Message	Cause	Action
Pr 1 d iSC	Cabinet temperature probe open	• Check connections • Replace probe
Pr 1 Short CC	Cabinet temperature probe short-circuited	
Pr 2 d iSC	Defrost probe open	• Check connection • Replace probe
Pr 2 Short CC	Defrost probe short-circuited	
Int Error	Internal memory error	• Replace controller
StArt dELAY	Start up delay in progress	• Wait for 6 minutes





## CONTROLLER ALARMS AND SIGNALS CONT...

Message	Cause	Action
H I ALARM	High temperature alarm in progress	<ul style="list-style-type: none"> <li>• Check door</li> <li>• See Troubleshooting (page 15)</li> </ul>
LO ALARM	Low temperature alarm in progress	<ul style="list-style-type: none"> <li>• Adjust set temperature</li> </ul>
door OPEN	Door open	<ul style="list-style-type: none"> <li>• Close door</li> </ul>
CC CYCLE	"Turbo" mode active	<ul style="list-style-type: none"> <li>• none</li> </ul>
H I LO DELAY	Alarm delay after a restocking command	<ul style="list-style-type: none"> <li>• Press the door switch 3 times repeatedly within 5 seconds to enable restocking.</li> </ul>

## CONTROLLER SYMBOLS AND FUNCTIONS



At the left side of the controller display are the following LED indicators:

-  1. Indicates compressor status:  
 Light on - Compressor cooling on  
 Light off - Compressor cooling off  
 Light flashing - Start-up delay in progress
-  2. Indicates defrost status:  
 Light on - Defrost in progress  
 Light flashing - Refrigerator in dripping mode
-  3. Indicates fan status:  
 Light on - Cabinet fan ON  
 Light off - Cabinet fan OFF  
 Light flashing - Start-up delay in progress after defrost.
-  4. Indicates the alarm status:  
 Light on - Alarm is on  
 Light off - Alarm is off  
 Light flashing - Alarm silenced or memorized

## CONDENSER CLEANING

The refrigerator is designed for minimal condenser cleaning. With the "lint free" condenser design, most dust and dirt will pass right through the condenser. To insure the proper operation, we recommend scheduled check-ups and cleaning every three to four months. This period may be shorter or longer depending on the location in which the refrigerator was installed. A dirty condenser can result in a voided warranty, part failure, product loss, and higher electrical cost. The steps to clean the condenser are as follows:

1. Remove the front bottom grill (see page 10)
2. Switch off power at refrigerator switch on control panel.
3. Unplug power cord from electrical receptacle.
4. Brush the dirt, dust and paper off the condenser coil plate, all the way to the fan. Use either a vacuum or blow with a compressed air supply if available.
5. When finished with cleaning, plug power cord back into receptacle.
6. Switch power back on at switch on control panel.
7. Replace bottom grill (see page 10)

### NOTE:

The cleaning of the condenser is a service not covered under the warranty

## CABINET CLEANING

### ⚠ WARNING

To reduce the risk of fire, electrical shock or personal injury, disconnect the refrigerator from the power source before cleaning. Press the refrigerator switch to the "Off" position, then unplug the power cord from the receptacle. Keep liquids away from electrical and electronic components.

### ⚠ CAUTION

Do not apply hot water on cold glass components. Allow glass to warm sufficiently to prevent shattering.

### ⚠ CAUTION

Do not use ammonia or bleach based cleaners or abrasive type cleaners.  
Do not use abrasive cleaning pads.

To clean the exterior whether it has the original finish or a decal package, use only a mild non-abrasive liquid cleaner, water and a soft cloth. For stainless steel parts, a commercial stainless steel polish and cleaner can be used. Always apply the cleaner to the soft cloth and then clean the refrigerator. Never apply the cleaner directly to the refrigerator. Excess liquid applied to the surface may seep into the electronic control and switches which can cause an electrical hazard or a malfunction.

**DO NOT USE** abrasive or caustic cleaners, scouring pads, solvents or flammable liquids.

## GENERAL

The refrigerator should be cleaned at regular intervals to meet a good standard of hygiene and to keep the refrigerator attractive as an effective point of purchase display.

## INTERIOR CLEANING

Use only mild non-abrasive liquid cleaner, water and a soft cloth for the entire refrigerator interior. Make sure to wipe off all residue.